

REPAIR PARTS FOR 45-0457 DETHATCHER

Want more information or assembly tips?



**Video
Instruction
Guide**

youtube.com/c/agrifab

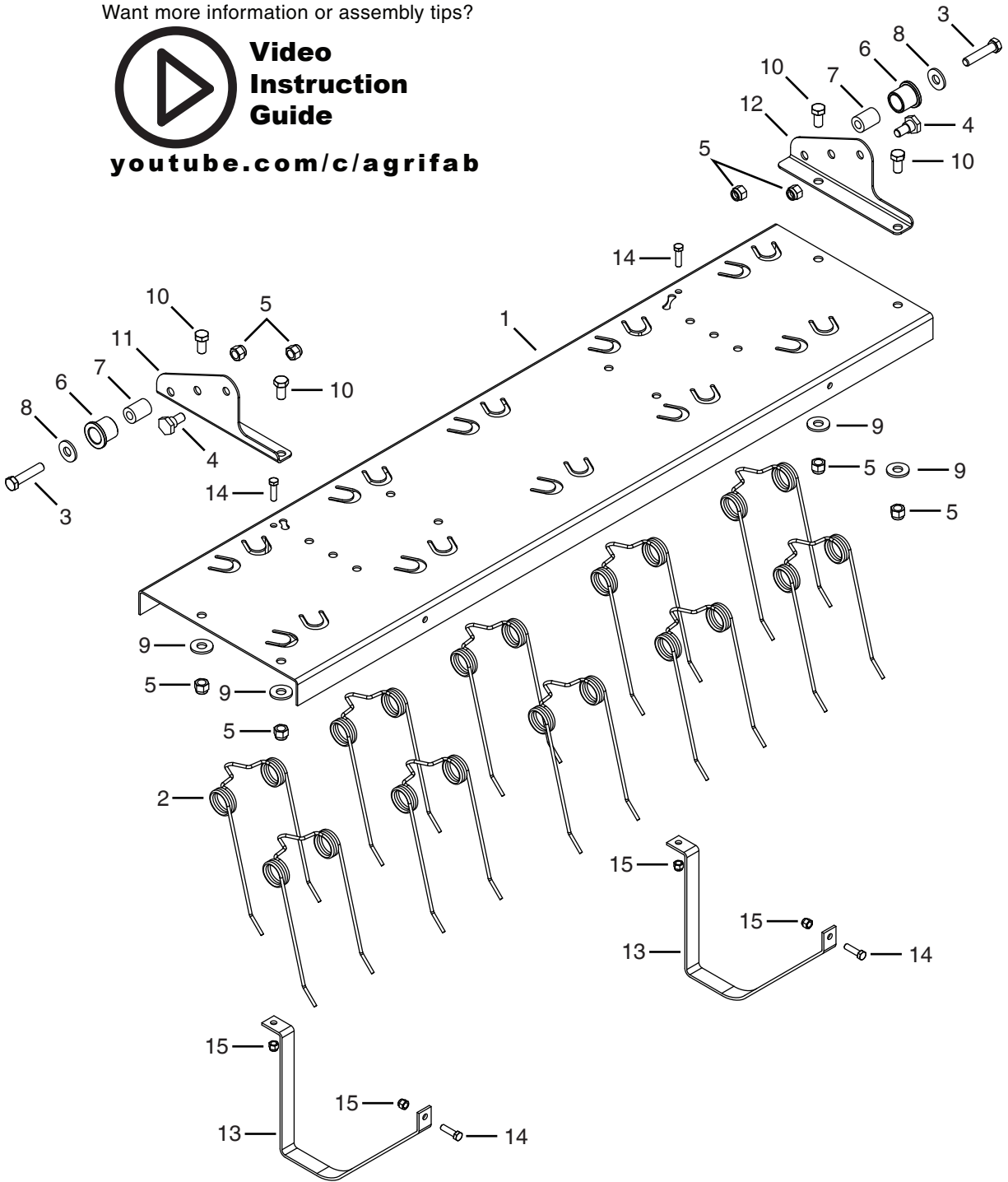

| REF | QTY | PART NO | DESCRIPTION | REF | QTY | PART NO | DESCRIPTION |
|-----|-----|---------|-----------------------------|-----|-----|---------|-------------------------|
| 1 | 1 | 24874 | Tine Spring Shield | 9 | 4 | 43081 | Washer, 5/16" |
| 2 | 10 | 46761 | Spring | 10 | 4 | 43407 | Hex Bolt, 3/8-16 x 3/4" |
| 3 | 2 | 41576 | Hex Bolt, 3/8-16 x 1-3/4" | 11 | 1 | 26600 | Bracket, RH |
| 4 | 2 | 48106 | Shoulder Bolt, 3/8-16 x .9" | 12 | 1 | 26601 | Bracket, LH |
| 5 | 8 | HA21362 | Nylock Nut, 3/8-16 | 13 | 2 | 26826 | Guage, Skid |
| 6 | 2 | 44798 | Flange Bearing | 14 | 4 | 43012 | Hex Bolt, 1/4-20 x 3/4" |
| 7 | 2 | 24286 | Spacer, .38 x .75 x 1" | 15 | 4 | 47189 | Nylock Nut, 1/4-20 |
| 8 | 2 | 43070 | Washer, 3/8" | 1 | 1 | 40753-D | Owners Manual |